

## iFIX Integration



# iFIX Integration Overview

SeQent's iFIX gateways monitor the alert queues of a iFIX project for alerts which match defined conditions. In addition, by using the SeQent OPC Gateways, iFIX data such as tags and calculated tags may also be monitored. Depending on the gateway selected, the actions may include:

- FirstPAGE software offers a generic interface to a multitude of messaging platforms, enabling simplified communication and configuration. With support for many output protocols or platforms, including email, SMS, databases, voice and two-way radios, combined with various connectivity options (serial, modem, TCP/IP, databases), it allows for a vast combination of custom implementations.
- FirstPAGE Alarm Manager monitors alarms and events. Should a monitored alarm or event occur, it will automatically escalate through a pre-defined hierarchy of responsible parties until acknowledged. It sends key information to the right person at the right time on whatever communication device that is configured for that individual.
- Marquee Manager software monitors manufacturing environments and sends real-time, automated messages (Alarms, Events, KPIs, OEE) to visual and audible devices, including LED/LCD displays, smartphones, tablets, and sounder devices.

SeQent's iFIX gateways support all versions of iFIX V6.1 or higher.

# iFIX Integration Architecture Overview



PLC



PLC



PLC



PLC



CNC



PLC

## Application Server 1



- OPC Servers
- iFIX
- FirstPAGE Gateway for OPC
- FirstPAGE Alarm Manager Gateway for iFIX

## Application Server 2



- OPC Servers
- iFIX
- FirstPAGE Gateway for OPC
- FirstPAGE Alarm Manager Gateway for iFIX

## Application Server 3



- OPC Servers
- iFIX
- FirstPAGE Gateway for OPC
- FirstPAGE Alarm Manager Gateway for iFIX

Data Flow

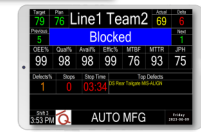
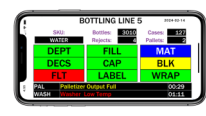
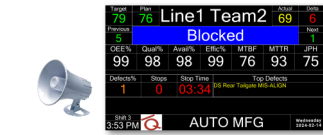

## Visualization/Messaging Server



- FirstPAGE Server
- FirstPAGE Alarm Manager Server
- Marquee Manager Server
- Wi-Fi Messenger Server



Internet



MOTOTRBO



# iFIX Integration

## Application Server Overview

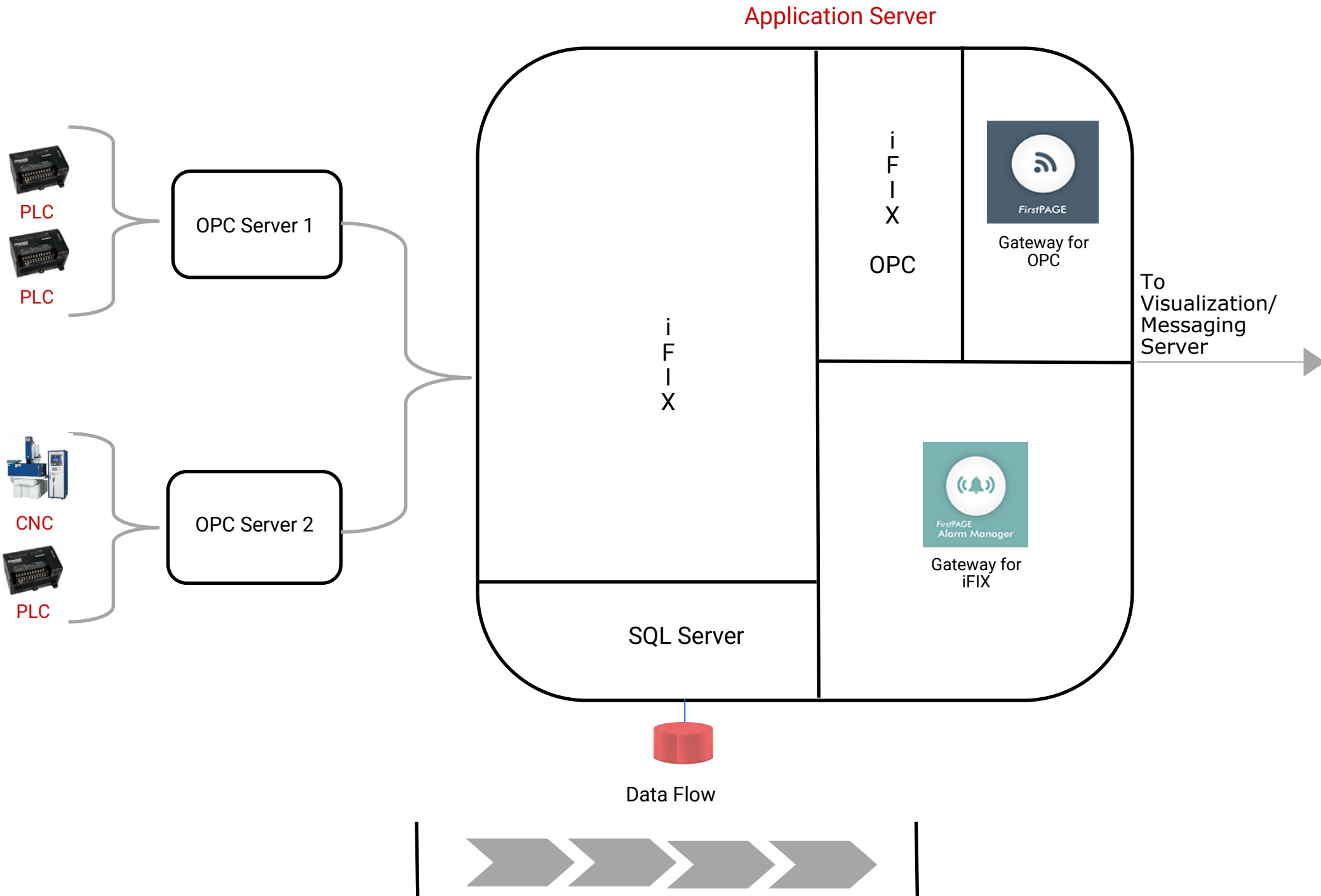

Application Server



OPC Server 1



OPC Server 2

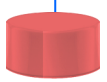
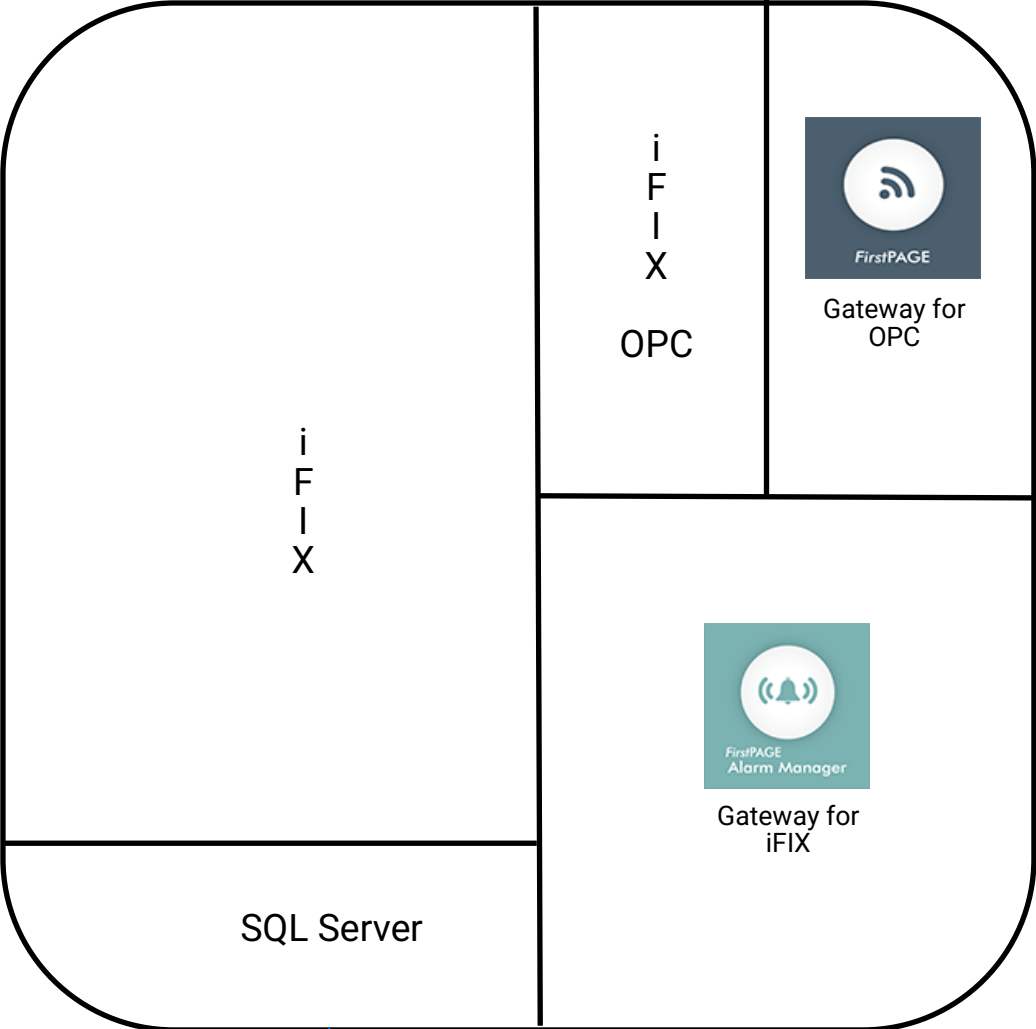

Data Flow

To Visualization/  
Messaging  
Server



# iFIX Integration

## Visualization/Messaging Server Overview

### Visualization/Messaging Server

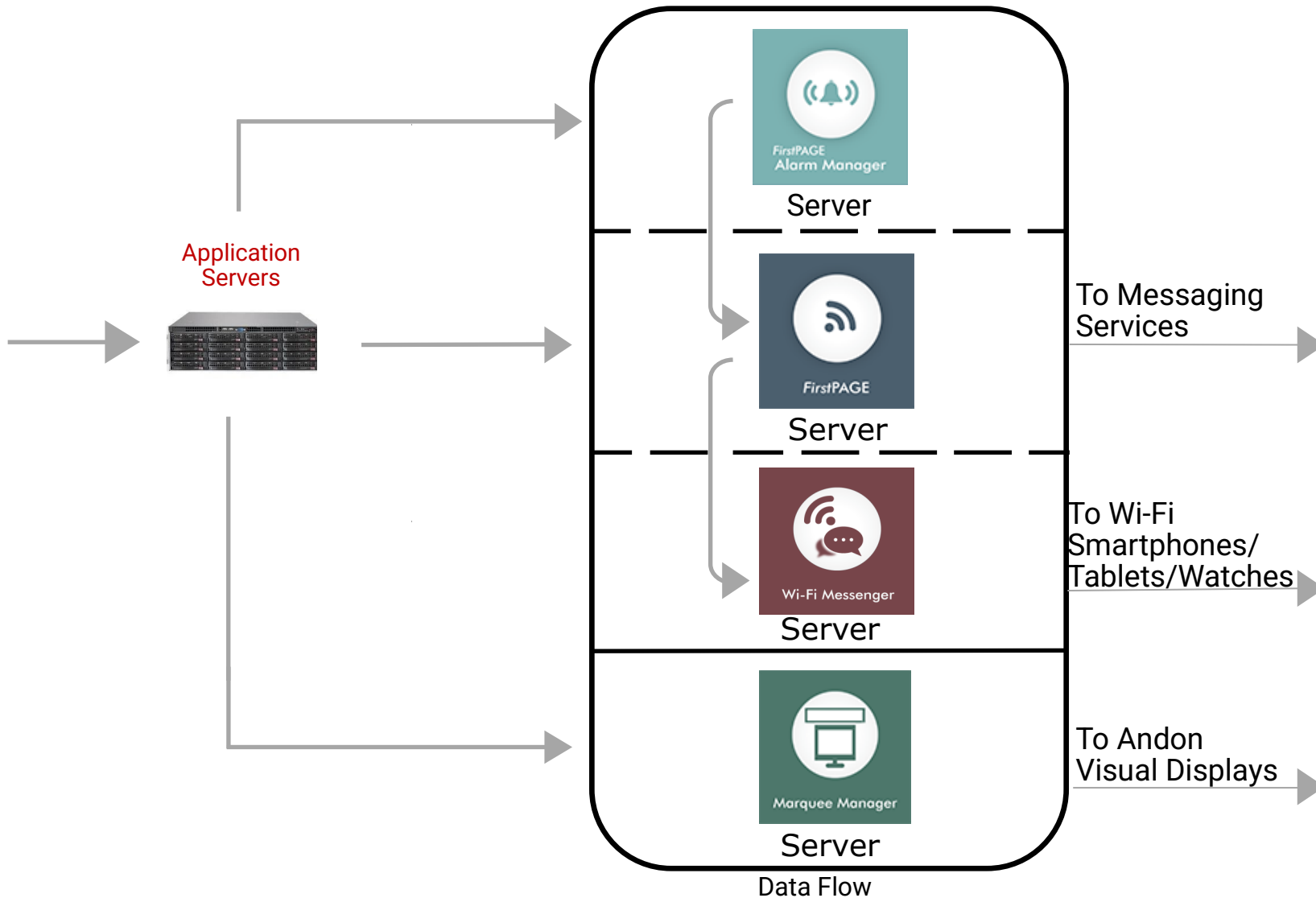



**For additional information on solutions offered by SeQent, please contact our sales group:**



**4500 Blakie Road, Suite 137  
London, ON N6L 1G5  
Canada**



**+1.519.652.0401**



**[Sales@SeQent.com](mailto:Sales@SeQent.com)**



**[www.SeQent.com](http://www.SeQent.com)**